

USER'S MANUAL

Vidos

duc

2 wire system video door intercom

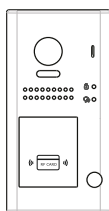

S1101A

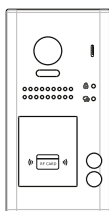

S1102A

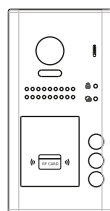

S1103A

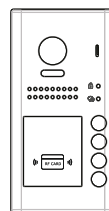

S1104A

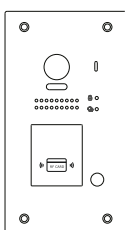

S1201A

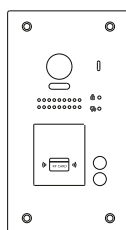

S1202A

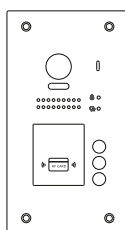

S1203A

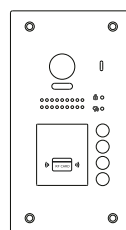

S1204A

Door station

INTRODUCTION

Before you start to assemble and use the device, please read this user's manual carefully. In case of any problems with understanding its contents, please contact your seller of the device. You can install and commission the device yourself if you have the basic knowledge of electronics and use appropriate tools. It is recommended to install the device by the qualified personnel. The manufacturer is not liable for damages which may result from your incorrect installation or operation of the device or from making repairs and modifications on your own.

CHARACTERISTICS OF THE SYSTEM

VIDOS is a state-of-the-art solution characterised by its exceptional ease of configuration and installation. The system operation is based on the simplicity of connection through 2 non-polarity wires only.

It can be extended with additional options by using dedicated modules, which are also connected with 2 wires. Thanks to the application of the proven signal modulation techniques, transmitted video and sound stand out with their very good quality at every point of your installation.

BASIC FEATURES OF THE VIDOS DUO SYSTEM:

- Up to 4 door stations can be connected
- Maximum 32 places in the system at its basic configuration
- Addressed intercom in-between monitors
- 1 power supply for the whole system
- 2 wire connections (non-polarised) between each point within the entire system
- CCTV camera application feature (4 CCTV cameras as standard)
- GSM module as an optional solution to receive calls on the telephone
- Distance from a door station to the furthest monitor - 150 m; this range can be extended up to 300 m when using the module M-3F
- Lighting control feature

RoHS **CE** 

CONTENTS

PARTS AND FUNCTIONS	3
Part Names.....	3
Mounting	4
BASIC FUNCTIONS	6
Unlock Operations	6
Fisheye Camera	6
External Motion Detection	6
SETUP INSTRUCTIONS	7
Functions Setting Up	7
Setting Door Station Address	8
Setting Door Station Calling Mode	8
Setting Camera Resolution.....	10
Setting Unlock Mode	10
Setting Unlock Time.....	11
Setting Nameplate Illumination Mode	11
Setting Night View LED Illumination Mode	12
Setting Ring-back Tone	12
Setting Image Display Mode.....	13
Registering ID Card	14
WIRING	17
Connecting Electric Lock	17
Connecting Basic One-to-one	18
Connecting Multi Door Stations	18
Connecting Multi Monitors	19
APPENDIX	21
Precautions.....	21
Specification	21
Cables and Requirments	22
Warrant card	24

PARTS AND FUNCTIONS

Part Names

Surface mounted: S1101A/S1102A/S1103A/S1104A

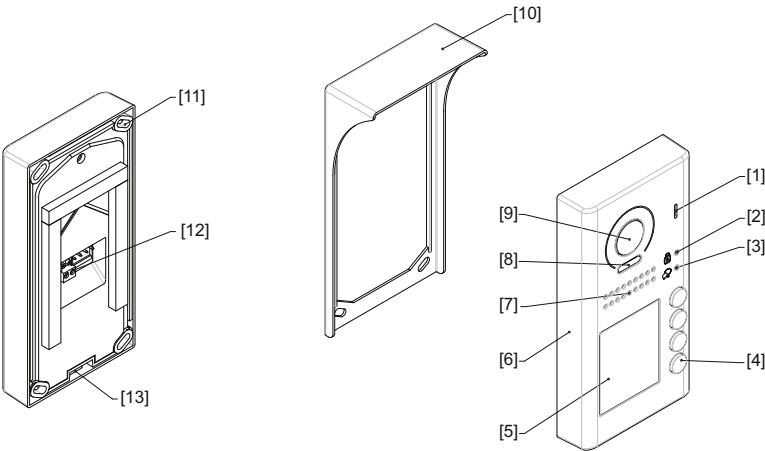

Flush mounted: S1201A/S1202A/S1203A/S1204A

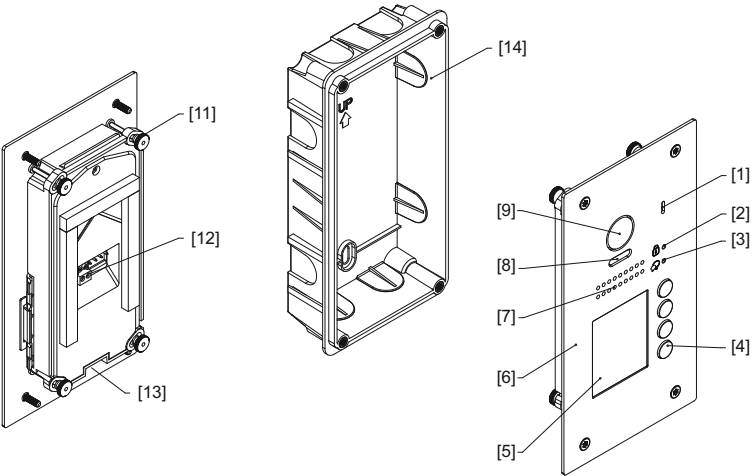

- | | | |
|----------------------|--------------------|----------------------|
| [1] Microphone | [5] Nameplate | [10] Rainy cover |
| [2] UNLOCK indicator | [6] Front panel | [11] Mounting hook |
| [3] CALL indicator | [7] Speaker | [12] Connection port |
| [4] Call button | [8] Night view LED | [13] Screw hole |
| | [9] Camera lens | [14] Mounting box |

PARTS AND FUNCTIONS

Mounting

The installation height is suggested to 145~160cm.

Surface mounted: S1101A/S1102A/S1103A/S1104A

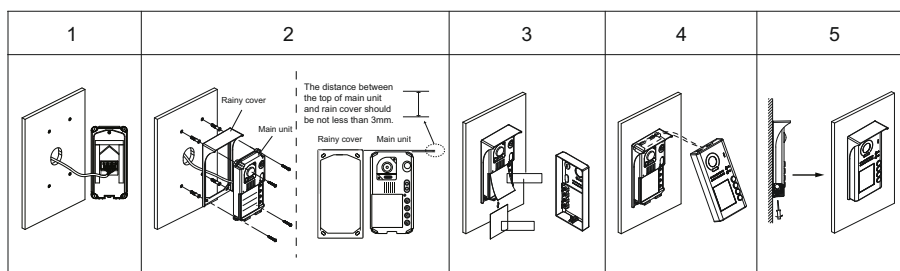

1. Connect the cable correctly.
2. Drill holes in the wall to match the size of wall stoppers, then attach the rainy cover and main unit to the wall, and the distance between the top of main unit and rain cover should be not less than 3mm.
3. Install the name plate.
4. Attach the front panel to the main unit.
5. Use the special screwdriver and the screws to fix the panel.

Flush mounted: S1201A/S1202A/S1203A/S1204A

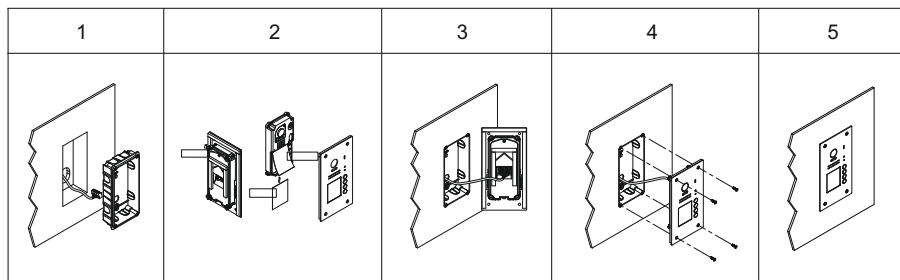

1. Drill a hole in the wall to match the size of mounting box, then attach the mounting box to the wall.
2. Loosen the high screws to install the name plate.
3. Connect the cable correctly.
4. Attach the front panel to the mounting box, then use the special screwdriver and the screws to fix the panel.
5. Finish the installation.

* The camera angle view of surface mount model may be less than 170°.

PARTS AND FUNCTIONS

Terminal description

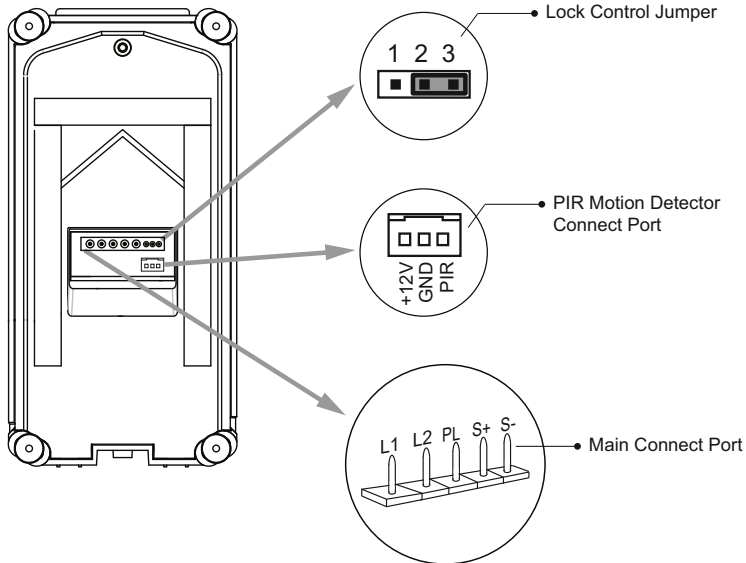

Lock Control Jumper: To select the lock type.

Motion Detector Connect Port: To connect external PIR motion detector with DC12V voltage and load up to 350mA..

Main Connect Port: To connect the bus line and the electronic locks.

- L1,L2: Connect to the bus line, no polarity.
- PL: External lock power input, connect to the power positive(power +).
- S+: Lock power(+) output.
- S-: Lock power(-) output, connect to the power(-) input of locks(only when using the door station to power the locks, if using the external power supply for the locks, the S- will not be connected).

BASIC FUNCTIONS

Unlock Operations

Unlocking of ID Card

When the registered user card has been shown to ID card window, the UNLOCK indicator lights up, the buzzer sounds, and the electric door strike is unlocked.

- If show the authorized user card, the buzzer will sound of beep+, and the UNLOCK indicator will light up.
- If show the unauthorized user card, the buzzer will sound of beep, beep, beep.

Fisheye Camera

Please note that this function requires the monitor with fisheye function to support.

The angle view is 170° , visitors in this angle view can be seen clearly and can be zoomed to see individuals up close via indoor monitor with fisheye function.

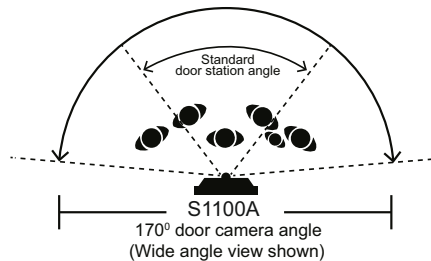

Models S1101A / S1102A / S1103A / 1104A are equipped with a lens with 105° viewing angle in width

Models S1201A / S1202A / S1203A / 1204A are equipped with a lens with 170° viewing angle in width..

External Motion Detection

The door station is equipped with a terminal to connect external motion detector.

If the external motion detector is connected to the system, following functions will be effective:

If detect someone passing by, the door station can be activated operation to unlock or turn on light.

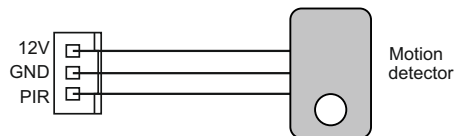

Specifications of the output:
voltage: DC12V
load: up to 350mA

IMPORTANT!

Motion detection is an additional function, that can be controlled and configured from a monitor adapted to its operation. (M1021)

SETUP INSTRUCTIONS

Functions Setting Up

This section explains the settings of each function, please refer to the following table:
 To perform the settings for the function you want, you should move away the metal front panel. Please refer to the sketch map.

Each operation is indicated by the lighting up of the LED indicator on the unit, and by the sounding of the buzzer.

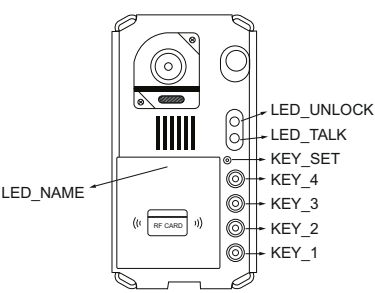

Order	Setting items	Setting range	Default value
1	Setting door station address	0~3	0
2	Setting door station calling mode	Standard/Group calling mode	Standard calling mode
3	Setting camera resolution	High/Low	High
4	Setting the unlock mode	0:opened/1:closed	0:opened
5	Setting the unlock time	01 to 99 seconds	3 seconds
6	Setting the nameplate illumination mode	On/Off/Auto	On
7	Setting night view LED illumination mode	On/Off/Auto	Auto
8	Setting ring-back tone	Ringing one time Ring continuously No ring-back tone	Ringing one time
9	Setting image display mode	Alternate switching mode Zoom mode Full screen mode	Alternate switching mode

SETUP INSTRUCTIONS

Setting Door Station Address

Total 4 addresses can be configured. It can be modified either before or after installation.
0 is default, to change the setting, please follow the steps:

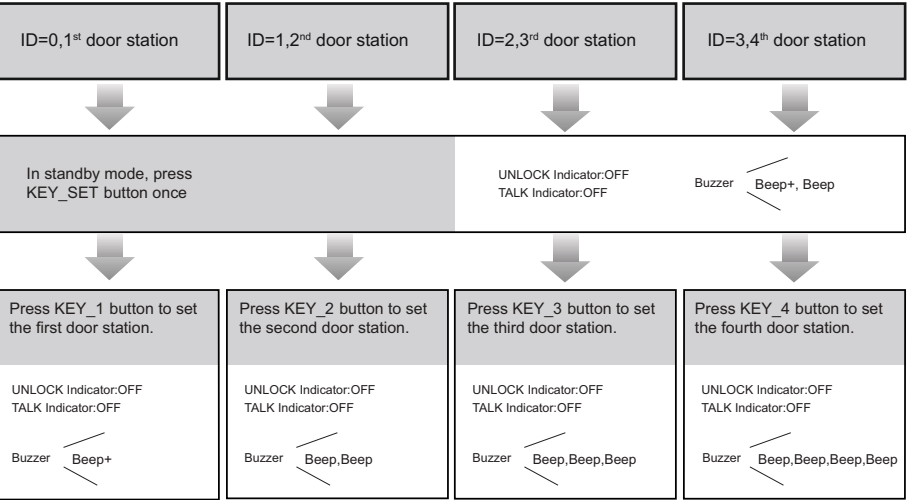

- If setting mode has not been exited, you can change the address of door station by pressing KEY1~4 freely.
- The LED_NAME indicator will always blink until exit out the setting mode.
- If without any operation in 10 seconds, it will exit out setting mode automatically.
- In this step, press KEY_SET button four times to exit out the setting mode manually.

Setting Door Station Calling Mode

There are two calling modes for door station, Standard calling mode and Group calling mode.
Please know that the door station work in Standard calling mode by default.

SETUP INSTRUCTIONS

Each call button will respond different addresses when set in different calling mode. Refer to the followings for more informations.

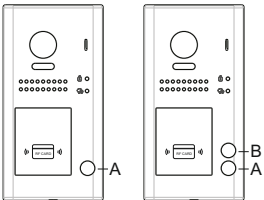

1.Standard calling mode(Address range 01-04 by default)

- Call buttonA: call the monitor with address 01 by default.
- Call buttonB: call the monitor with address 02 by default.
- Call buttonC: call the monitor with address 03 by default.
- Call buttonD: call the monitor with address 04 by default.

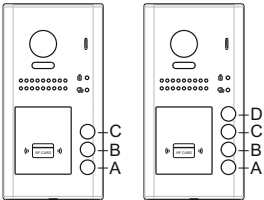

2.Group calling mode

- Call buttonA: Call all monitors in group address from 00~15.(one of the monitor should be set to 00)
- Call buttonB,C,D: Call all monitors in group address from 16~31. (one of the monitor should be set to 16)

* More details about code setting for monitor, please refer to corresponding user manual .

To change this setting, please follow the steps:

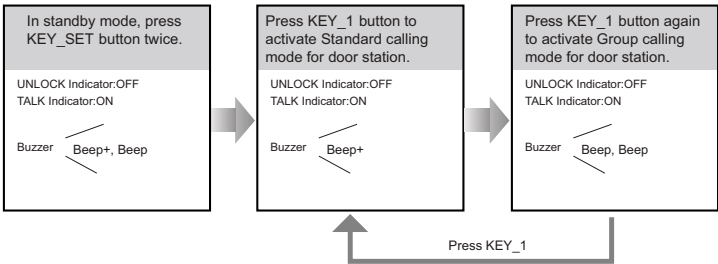

- If setting mode has not been exited, you can change the calling mode by pressing KEY1 circularly.
- The LED_NAME indicator will blink all the time until exit out the setting mode.
- If without any operation in 10 seconds, it will exit out setting mode automatically.
- In this step,press KEY_SET button three times to exit out the setting mode manually.

SETUP INSTRUCTIONS

Setting Camera Resolution

The resolution of the camera can be adjusted at any time, that means the quality of image on screen can be set to high or low.

High resolution is default, to change the setting, please follow the steps:

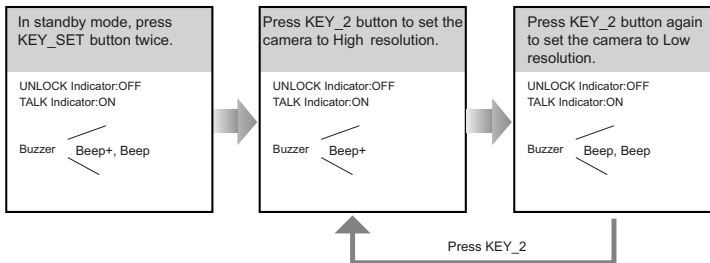

- If setting mode has not been exited, you can change the camera resolution by pressing KEY2 circularly.
- The LED_NAME indicator will blink all the time until exit out the setting mode.
- If without any operation in 10 seconds, it will exit out setting mode automatically.
- In this step, press KEY_SET button three times to exit out the setting mode manually.

Setting Unlock Mode

There are 2 unlock modes, Normally opened and Normally closed .

Normally opened is default, to change the setting, please follow the steps:

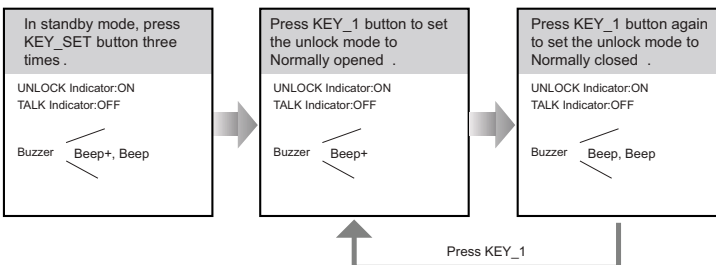

- If setting mode has not been exited, you can change the unlock mode by pressing KEY1 circularly.
- The LED_NAME indicator will blink all the time until exit out the setting mode.
- If without any operation in 10 seconds, it will exit out setting mode automatically.
- In this step, press KEY_SET button twice to exit out the setting mode manually.

SETUP INSTRUCTIONS

Setting Unlock Time

By default, the unlock time is 1s, but it can be changed, the setting range is 1s~99s.

Follow the steps:

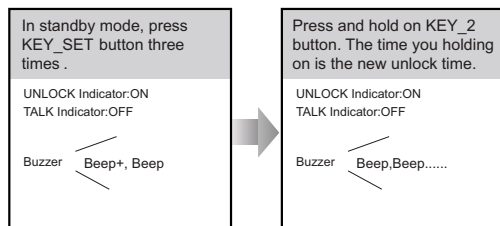

- When entering time delayed setting, the buzzer sound one time every second.
- The LED_NAME indicator will blink all the time until exit out the setting mode.
- If without any operation in 10 seconds, it will exit out setting mode automatically.
- In this step, press KEY_SET button twice to exit out the setting mode manually.

Setting Nameplate Illumination Mode

There are 3 illumination modes for nameplate indicator, Normally on ,Normally off and Auto .

Normally on is default, to change the setting, please follow the steps:

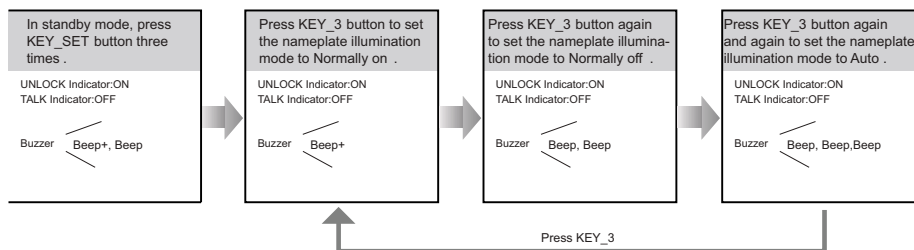

- If setting mode has not been exited, you can change the nameplate illumination mode by pressing KEY3 circularly.
- The LED_NAME indicator will blink all the time until exit out the setting mode.
- If without any operation in 10 seconds, it will exit out setting mode automatically.
- In this step, press KEY_SET button twice to exit out the setting mode manually.

SETUP INSTRUCTIONS

Setting Night View LED Illumination Mode

There are 3 working modes for night view LED indicator, Normally on ,Normally off and Auto .

Auto is default, to change the setting, please follow the steps:

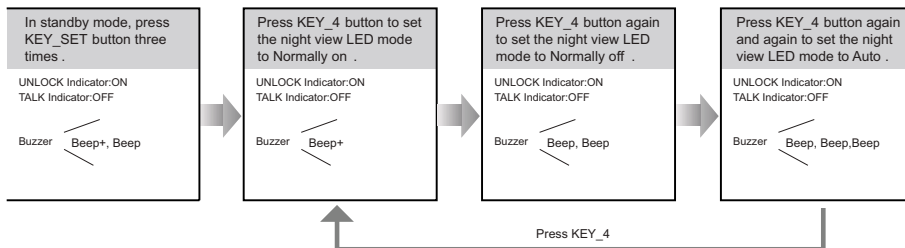

- If setting mode has not been exited, you can change the night view LED illumination mode by pressing KEY4 circularly.
- The LED_NAME indicator will blink all the time until exit out the setting mode.
- If without any operation in 10 seconds, it will exit out setting mode automatically.
- In this step,press KEY_SET button twice to exit out the setting mode manually.

Setting Ring-back Tone

If allow ring-back tone, press the call button to call monitor, a ring-back call tone can be heard from door station.

There are 3 ring-back call tones, Ringing one time ,Ringing continuously and No ring-back tone .

Ringing one time is default, to change the setting, please follow the steps:

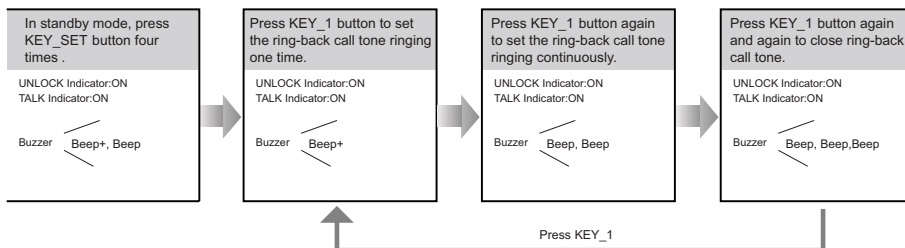

- If setting mode has not been exited, you can change the ring-back tone by pressing KEY1 circularly.
- The LED_NAME indicator will blink all the time until exit out the setting mode.
- If without any operation in 10 seconds, it will exit out setting mode automatically.
- In this step,press KEY_SET button once to exit out the setting mode manually.

SETUP INSTRUCTIONS

Setting Image Display Mode

Please know that this setting is only effective for monitors which does not support manual operation for pan-tilt.

When the monitor being called

When door station calls monitor,the image will be displayed on screen,there are 3 modes for image displayed, **Alternate switching mode**,**Zoom mode** and **Full screen mode**.

Alternate switching mode: when the monitor being called, switch at regular time(5s) between **Full screen** and **Zoom** image.

Zoom mode: when the monitor being called, the image will be displayed on full screen for 5 seconds, then switch to **Zoom** image.

Full screen mode: when the monitor being called, the image will be always displayed on **Full screen**.

Alternate switching mode is default, to change the setting, please follow the steps:

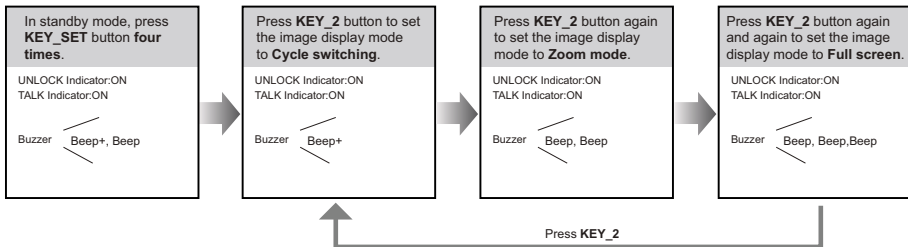

- If setting mode has not been exited, you can change the image display mode by pressing KEY2 circularly.
- The **LED_NAME** indicator will blink all the time until exit out the setting mode.
- If without any operation in 10 seconds, it will exit out setting mode automatically.
- In this step,press **KEY_SET** button once to exit out the setting mode manually.

When answering the call

When answering the call, the image switching reminder can be activated or forbidden.

If set to activated mode, the image switching reminder will be different for different image display mode.

Alternate switching mode: When answering the call, image switching reminder is not effective.

Zoom mode: When answering the call, the image will be displayed on **full screen** for 5 seconds, then switch to **Zoom** image to remind to enter talking status.

SETUP INSTRUCTIONS

Full screen mode: When answering the call, the image will be displayed on Zoom mode for 5 seconds, then switch to Full screen to remind to enter talking status.

If set to forbidden mode, there is no image switching reminder at any image display mode.

Activated is default, to change the setting, please follow the steps:

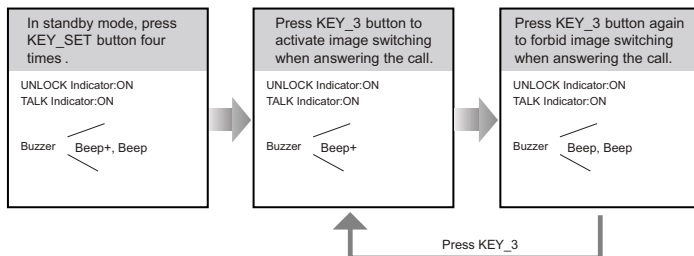

- If setting mode has not been exited, you can change the image display mode by pressing KEY3 circularly.
- The LED_NAME indicator will blink all the time until exit out the setting mode.
- If without any operation in 10 seconds, it will exit out setting mode automatically.
- In this step, press KEY_SET button once to exit out the setting mode manually.

Registering ID Card

- Up to 320 user cards can be registered by the door station.
- Easy management with LED status and sound hints.
- There are two master cards, one MASTER CARD ADD card and one MASTER CARD DELETE card, When registered new master cards, the old master cards are invalid automatically.
- Card reading distance is less than 3cm.
- The master cards are necessary when you add or delete user cards. Please keep it well for future use.
- EM card, 125kHz.

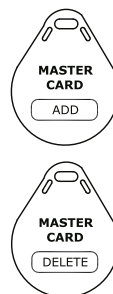

Authorizing master cards:

By default, there are two master cards marked MASTER CARD ADD and MASTER CARD DELETE, but you should know that the master card can be authorized by users at any time. That means any two user cards can be authorized to master cards, When registered new master cards, the old master cards will be invalid automatically.

SETUP INSTRUCTIONS

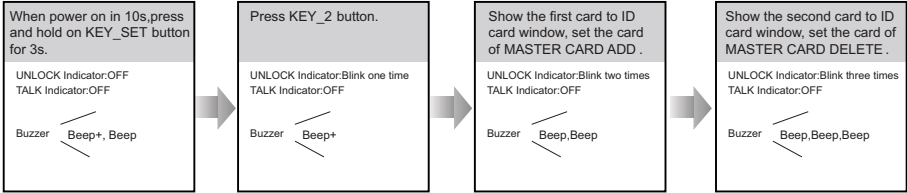

- The LED_NAME indicator will always blink until exit out the master card authorized mode.
- If without any operation in 10 seconds, it will exit out setting mode automatically.
- It will exit out setting mode automatically after showing these two cards, the UNLOCK&TALK indicator will be turned off.

Switching Access Control:

The access can be controlled by door station or DT-ACC, so it's available to switch the access function.

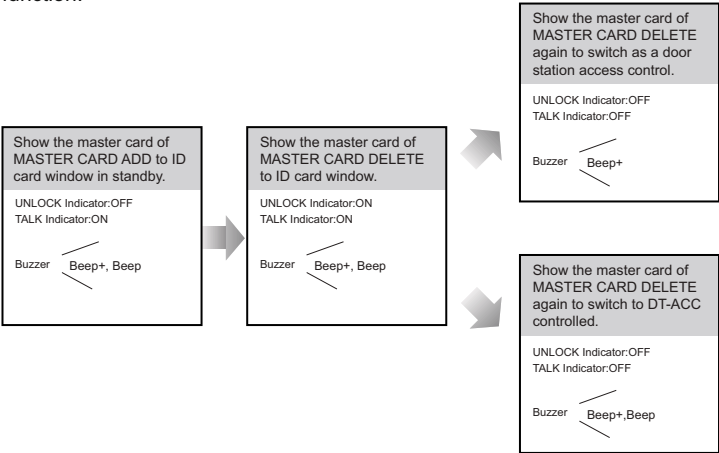

- If without any operation in 10 seconds, it will exit out setting mode automatically.
- If current access is controlled by door station, next access switching setting is controlled by DT-ACC.

Adding User Cards:

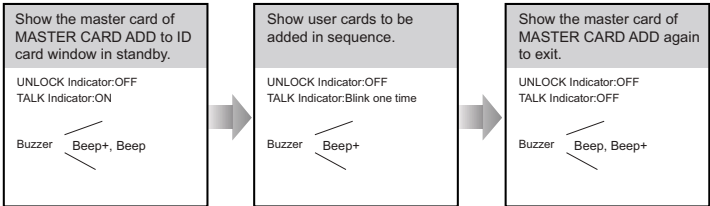

- If without any operation in 10 seconds, it will exit out setting mode automatically.
- To add user card, the access must be controlled by door station.

SETUP INSTRUCTIONS

Deleting User Cards:

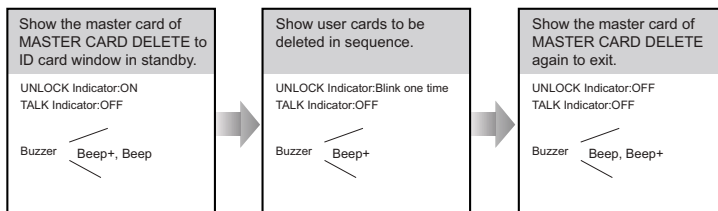

- .If without any operation in 10 seconds, it will exit out setting mode automatically.
- To add user card, the access must be controlled by door station.

Initializing Access (delete all user cards):

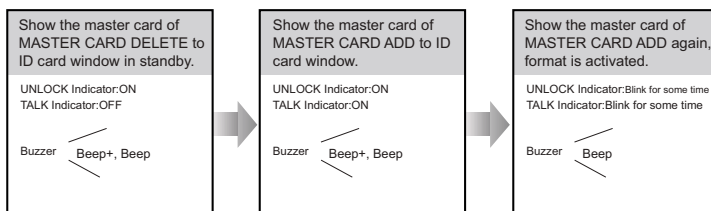

- If without any operation in 10 seconds, it will exit out setting mode automatically.
- To add user card, the access must be controlled by door station.
- At step3, the UNLOCK & TALK indicator will blink all time until formatting is finished.
- When formatting is finished, UNLOCK & TALK indicator will be turned off and sound " Beep+ ", and exit out setting mode automatically.

Reset - return to the factory settings

- Turn off the power to the door station.
- Turn on the power supply within a max. of 5 seconds press the SET button for 3 seconds - go in setting mode.
- Press the SET button briefly.
- Press KEY 3 briefly, all LEDs light up, wait for 15 seconds, the door station will remain reset after this time.

Connecting Electric Lock

Door Lock Controlled with Internal Power

1. Electronic lock of Power-on-to-unlock type should be used.
2. The door lock is limited to 12V, and holding current must be less than 250mA.
3. The jumper should be placed on position 2 and 3 before connecting.
4. The door lock control is not timed from Exit Button(EB).
5. The Unlock Mode must be set to 0 (by default).

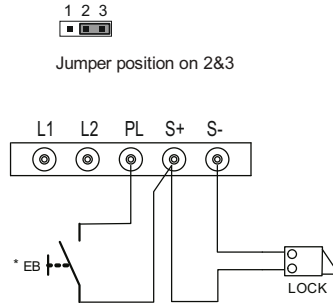

Door Lock Controlled with Dry Contact

1. The external power supply must be used according to the lock.
2. The inside relay contact is restricted to 230Vac 1A or 24Vdc 1A.
3. The jumper must be taken off before connecting.
4. Setup the Unlock Mode according to different lock types.

- Power-on-to-unlock type: Unlock Mode=0 (by default)
- Power-off-to-unlock type: Unlock Mode=1

B5 relay actuator is needed for 2nd lock connection.

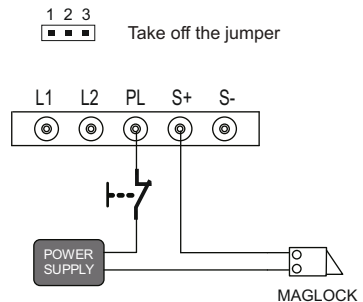
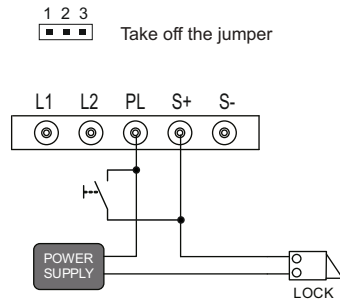

Connecting Basic One-to-one

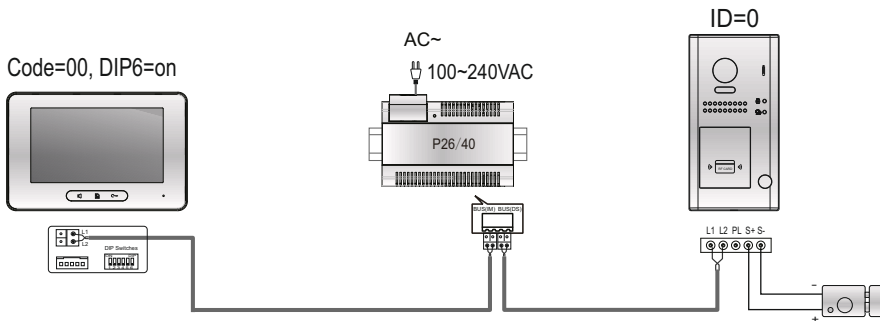

- The door station work in Standard mode in this situation. Refer to Page 9 in detail.
- The door station is also compatible with other monitors which are provided by our company.

Connecting Multi Door Stations with module M-SM4

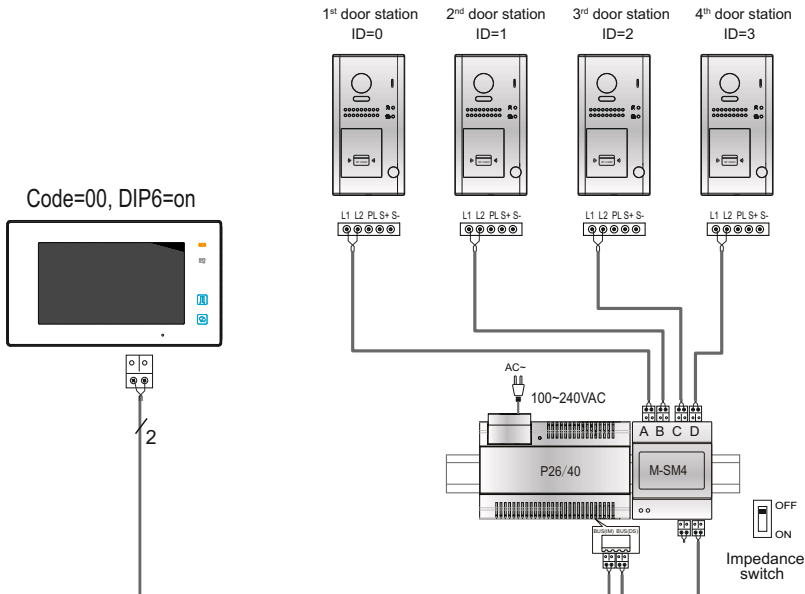

- Max.4 door stations can be connected to the system.
- If more than one door station is connected to one house, each should have a different address 0, 1, 2, or 3. Refer to Page 8 for more details about the address setting of door stations.

Connecting Multi Monitors

Basic IN-OUT Wiring in Standard Mode

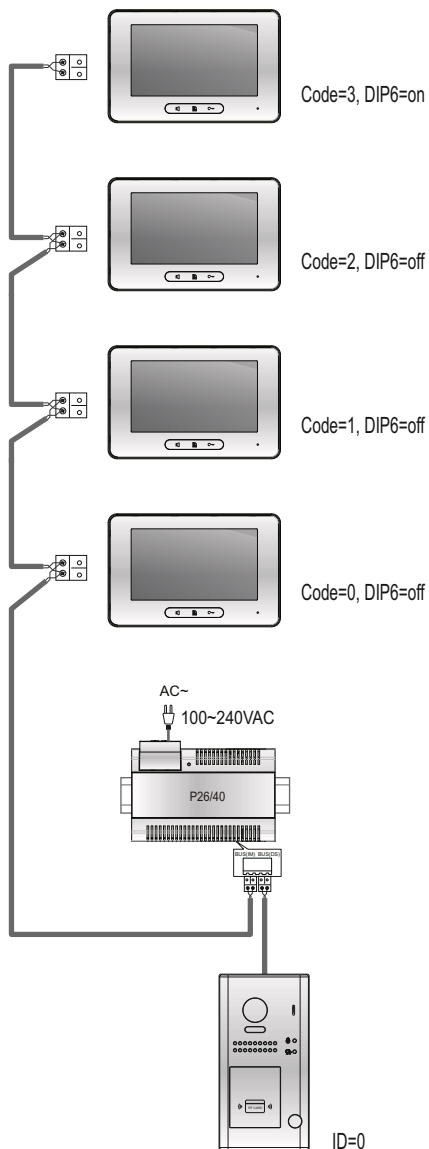

Setting the address of monitors for:

1. door station for one and two houses

First house

- the first monitor must have the address **0**, another monitors from **1** to **12**. In this we will get the addressed intercom.
We can install in one house up to 13 monitors.
- set the same address **0** at all monitors.
First as MASTER, another 3 monitors as SLAVE 1, 2, 3. In this way we will get the internal unaddressed intercom

Second house

- the first monitor must have the address **16**, another set from **17** to **28**. In this we will get the addressed intercom.
We can install in one house up to 13 monitors.
- set the same address **16** to all monitors. First set at MASTER, another 3 monitors on SLAVE 1, 2, 3. In this way we will get internal unaddressed intercom.

2. door station for three and four houses

- First house- address 01
- Second house - address 02
- Third house - address 03
- Fourth house - address 04
- Set the same address for all monitors in one house.
First as MASTER, further on SLAVE 1, 2 or 3

For the last monitor connected to the system, DIP6 should set to ON.

Star Topology Wiring With M-SM4 in Standard Mode

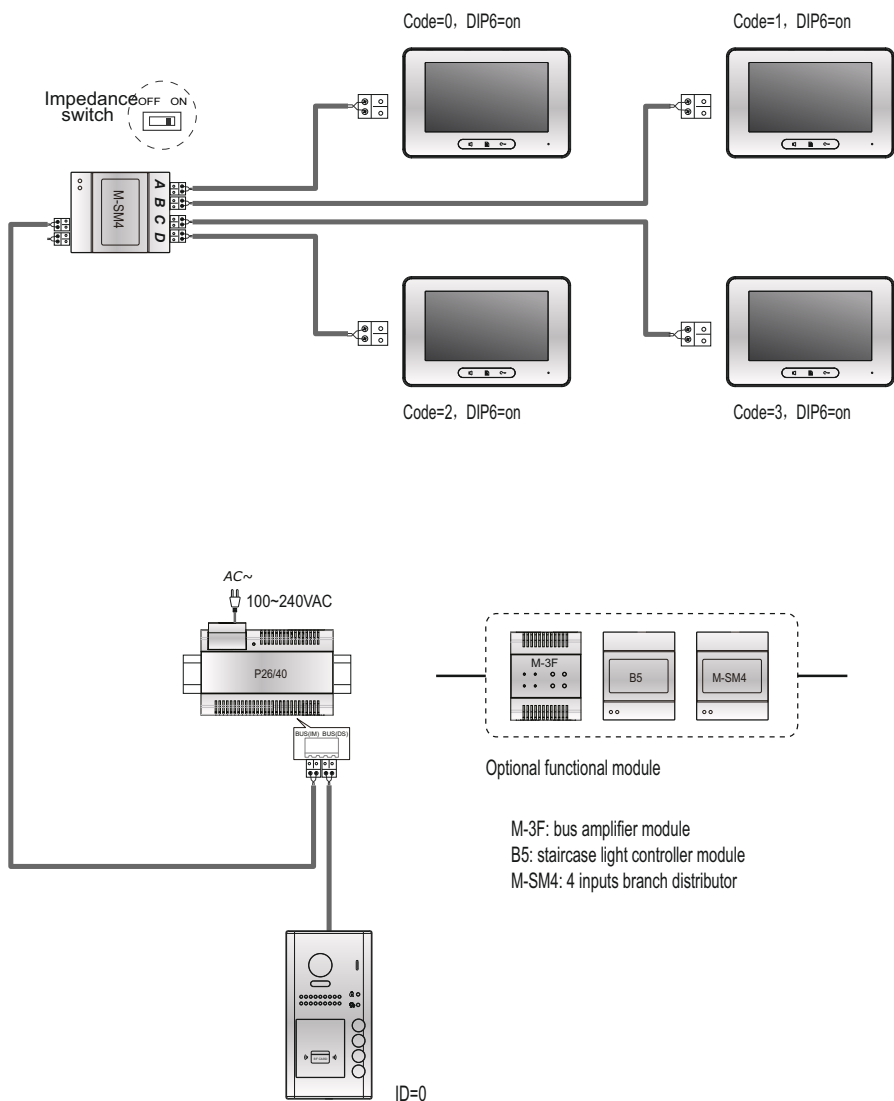

- The door station is also compatible with other monitors which are provided by our company.
- It can be extended 3 slave monitors for each monitor.(Better use with extra distributor for the extension)

Precautions

- Please clean the unit with soft cotton cloth, don't use the organic impregnant or chemical clean agent. If necessary, please use a little pure water or dilute soap water to clean the dust.
- The unit is weather resistant. However do not spray high pressure water on access control keypad directly. Excessive moisture may cause problems with the unit.
- You must use the right adaptor which is supplied by the manufacture or approved by the manufacture.
- Pay attention to the high voltage inside the products, please refer service only to a trained and qualified professional.

Specification

	Seria S1100	Seria S1200
Power supply:	DC 24V	
Power consumption:	Standby 0.8W; Working 3W	
Pixel	600TVL	2.0 Mega
The angle of view of the lens	105°	170°
Lock Power supply:	12Vdc, 280mA(Internal Power);	
Number of relay circuits:	2(the second lock need external device to support)	
Mounting:	Surface	wall-mount / flush mount
Working temperature:	-20°C ~ +55°C	
Protection:	IP54	
Material:	Zinc alloy panel	Stainless steel panel
Wiring:	2 wires, non-polarity	
Dimension:	176(H)×90(W)×27(D)mm	220(H)×119(W)×52(D)mm

Cables and Requirments

The maximum distance of the wiring is limited in the system, we recommend using twisted cable type YTKSY

Basic IN-OUT Wiring Mode

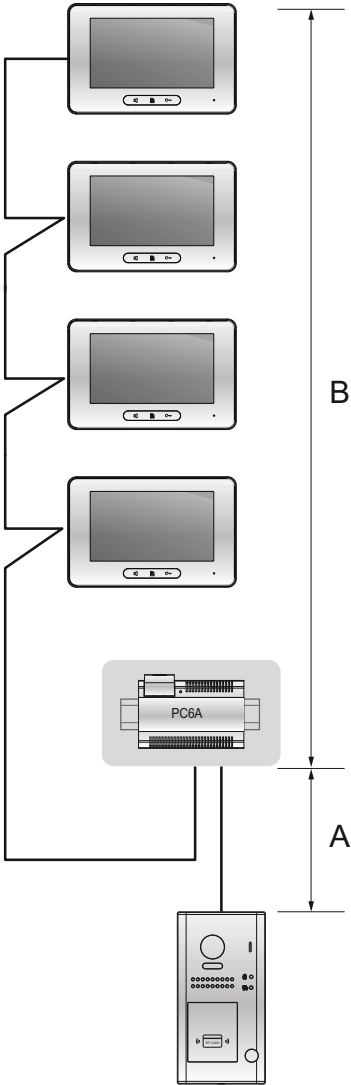

Cable and distance(unit:m)

Cable Usage	A	B	B
		≤2 IM	≤16 IM
Twisted cable 2x0.75mm ²	60	100	40
Twisted cable 2x1mm ²	80	120	60

Star Topology Wiring Mode With M-SM4

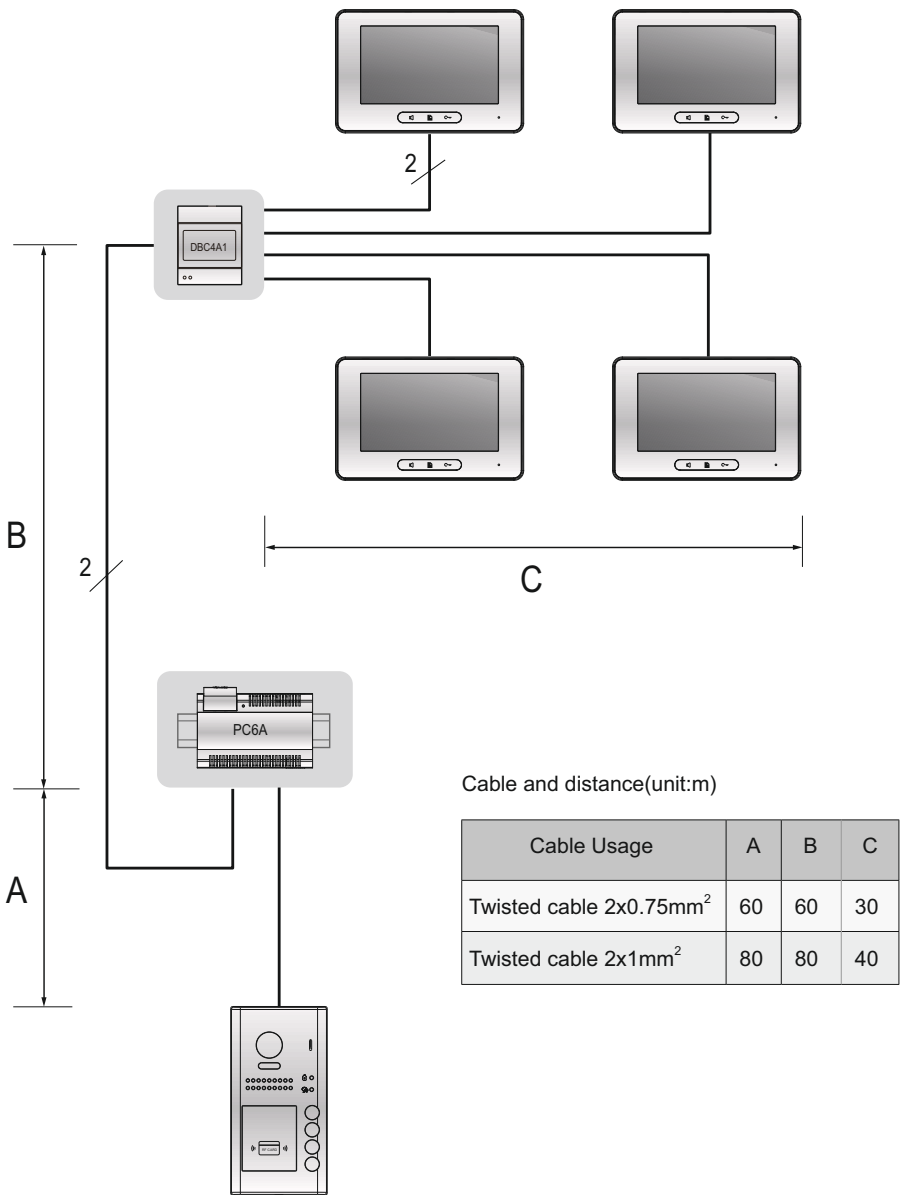

WARRANTY CARD

Product name: DOOR STATION

☐ S1101A ☐ S1102A ☐ S1103A ☐ S1104A
☐ S1201A ☐ S1202A ☐ S1203A ☐ S1204A

.....
Date of sale

Seller's seal and signature

1. Wena Company shall grant a warranty for the purchase of your product for a period of 24 months from the date of its purchase as shown on the present Warranty Card and the purchase document.
2. Product defects found during the warranty period shall be repaired free of charge within 21 working days from the date of acceptance of your product at the service centre.
3. The user has the right to replace the product with a new one if;
 - > four major repairs have been conducted during the warranty period and the product is still defective;
 - > when it is established that an unrecoverable defect has occurred. When replacing the product with a new one, the equivalent of items (including packaging) which are missing or damaged by the user as well as the cost of their replacement shall be deducted.
4. The user shall deliver the defective product at its own expense to the service centre.
5. The warranty shall not cover the deterioration of the product quality caused by standard wear and tear and in the following cases:
 - > the product has been used improperly or inconsistently with the product operating instructions;
 - > the product has been used or left in improper conditions (excessive humidity, too high or low temperature, sunlight, etc.), maintenance and operational condition which are different from the ones specified in the product operating instructions;
 - > mechanical, chemical and thermal damage;
 - > damage caused by external forces, e.g. overvoltage in the electrical network, atmospheric discharges, flood, fire;
 - > damage resulting from improper installation, improper storage of the device or repairs conducted by any unauthorised persons;
 - > damage due to incorrect voltage connection.
6. The guarantee shall cease to be valid as a result:
 - > breakage or damage of warranty seals;
 - > connection of additional equipment, other equipment than the one recommended by the product manufacturer;
 - > modifications and structural changes to the product and repairs conducted beyond the Wena service centre;
 - > the Guarantee Card or serial number have been changed, blurred or obliterated.
7. The Guarantee Card shall be valid only with the entered date of sale confirmed by the seller's seal and signature.
8. The condition to perform repair works is to deliver the Product with the Warranty Card and the proof of purchase.
9. Service Centre:

Firma Handlowa Wena
Al. Jerozolimskie 311 ,
05 - 816 Reguły / near Warsaw
Poland
tel. +48 228 370 286; +48 228 174 003
e-mail: biuro@vidos.pl
www.vidos.pl



Firma Handlowa Wena
Al. Jerozolimskie 311
05-816 Reguły/ near Warsaw
Poland
tel. +48 228 370 286; +48 228 174 008
e-mail: biuro@vidos.pl
www.vidos.pl